

# CROMWELL Qualfast. 5x36mm METRIC EXTRACTABLE DOWEL PIN C/W AIR FLAT

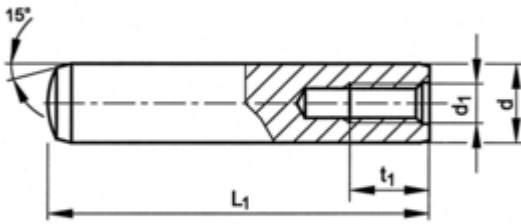

Cod comanda: **QFT6500238X**

## Descriere produs:

This range of Metric Extractable Dowel Pins with Air Flats are ideal for use when keeping machine components locked together or for aligning purposes. Available in a range of sizes, each component is manufactured from steel and has a plain finish. Features and Benefits

- o Available in a range of metric sizes to suit your needs
- o Manufactured from steel for maximum durability and product longevity
- o 'As produced' oiled finish (black) - Provides some shelf life but no real corrosion protection in use

Typical Applications

- o Engineering
- o Automotive
- o Construction Standards
- o DIN 7979D
- o NEN 2464
- o ISO 8735A

## Detalii tehnice:

### Dimensiuni ambalaj:

Lungime mm: 0

Latime mm: 0

Inaltime mm: 0

Greutate g: 0

## Set de livrare: