

## **CROMWELL Qualfast. 5x28mm METRIC EXTRACTABLE DOWEL PIN C/W AIR FLAT**

**Cod comanda:** **QFT6500238S**

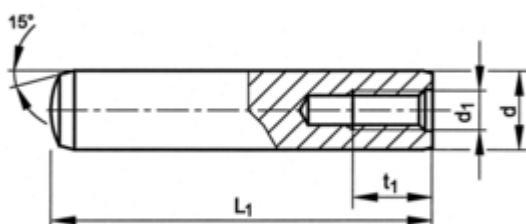

### **Descriere produs:**

This range of Metric Extractable Dowel Pins with Air Flats are ideal for use when keeping machine components locked together or for aligning purposes. Available in a range of sizes, each component is manufactured from steel and has a plain finish. Features and Benefits o Available in a range of metric sizes to suit your needs o Manufactured from steel for maximum durability and product longevity o 'As produced' oiled finish (black) - Provides some shelf life but no real corrosion protection in use Typical Applications o Engineering o Automotive o Construction Standards o DIN 7979D o NEN 2464 o ISO 8735A

### **Detalii tehnice:**

#### **Dimensiuni ambalaj:**

Lungime mm: 3

Latime mm: 0

Inaltime mm: 0

Greutate g: 4

### **Set de livrare:**