

CROMWELL Qualfast. 12x28mm METRIC EXTRACTABLE DOWEL PIN C/W AIR FLAT

Cod comanda: **QFT6500245S**

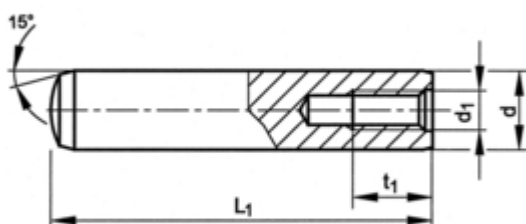

Descriere produs:

These metric extractable dowel pins are ideal for securing materials and marking points in machinery. The hollow structure allows the pin to be extracted with ease when needed and the product can be purchased in a range of lengths. Manufactured from steel with a plain, as produced finish. Features and Benefits

- o Available in a range of metric sizes to suit your needs
- o Manufactured from steel for durability
- o Air flat allows the pin to be extracted when necessary

Typical Applications

- o Engineering
- o Automotive
- o Construction Standards
- o DIN 7979D
- o NEN 2464
- o ISO 8735A

Detalii tehnice:

Dimensiuni ambalaj:

Lungime mm: 0
Latime mm: 0
Inaltime mm: 0
Greutate g: 0

Set de livrare: